

Performance Core Pins®

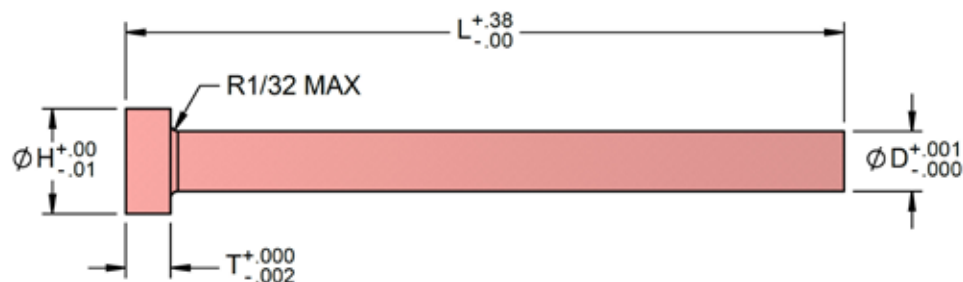

PCL

The Performance Core Pins® are an alternative for beryllium free copper alloy core pins. Choose from 61 sizes with 18 diameters ranging from 3/32" to 3/4" and lengths of 3", 6", 14" and 20". The Performance Core Pins are precision made from beryllium free copper alloy that dramatically increases the rate of heat transfer when compared to conventional steel core pins. The Performance Core Pins provide heat transfer results of 6-10 time better than steel core pins and twice the rate of beryllium-copper alloy core pins. Performance Core Pins can be titanium nitride (TiN) coated or chrome plated to provide wear resistance for abrasive filled resins applications. Titanium Nitride (TiN) coating is recommended on a Performance Core Pin in the sleeve application, although uncoated Performance Core Pins have worked well because of the reduced coefficient of friction between the copper alloy pin and the steel sleeve.

Features:

- Unit of measure: inch
- Beryllium Free
- Material: MoldStar® 150
- Hardness 95-98 Rockwell "B" (11-21 Rockwell "C")
- Higher tensile strength than P-20 tool steel
- Retains the inherent corrosion resistance of copper
- Reduces post-mold shrinkage problems
- Requires no additional heat treatment
- Six times better conductivity than steel
- Two times better conductivity than beryllium copper core pins



Performance Core Pins®

Item Number	Nominal Pin Diameter	D Actual Pin Diameter	L Overall Length	H Head Diameter	T Head Thickness
PCL0703	3/32"	0.0937	3"	0.25	0.125
PCL0706	3/32"	0.0937	6"	0.25	0.125
PCL0714	3/32"	0.0937	14"	0.25	0.125
PCL0903	1/8"	0.125	3"	0.25	0.125
PCL0906	1/8"	0.125	6"	0.25	0.125
PCL0914	1/8"	0.125	14"	0.25	0.125
PCL0920	1/8"	0.125	20"	0.25	0.125
PCL1103	5/32"	0.1562	3"	0.281	0.156
PCL1106	5/32"	0.1562	6"	0.281	0.156
PCL1114	5/32"	0.1562	14"	0.281	0.156
PCL1120	5/32"	0.1562	20"	0.281	0.156
PCL1203	11/64"	0.1718	3"	0.343	0.187
PCL1206	11/64"	0.1718	6"	0.343	0.187
PCL1214	11/64"	0.1718	14"	0.343	0.187
PCL1303	3/16"	0.1875	3"	0.375	0.187
PCL1306	3/16"	0.1875	6"	0.375	0.187
PCL1314	3/16"	0.1875	14"	0.375	0.187
PCL1320	3/16"	0.1875	20"	0.375	0.187
PCL1403	13/64"	0.2031	3"	0.375	0.187
PCL1406	13/64"	0.2031	6"	0.375	0.187
PCL1414	13/64"	0.2031	14"	0.375	0.187
PCL1503	7/32"	0.2187	3"	0.406	0.187
PCL1506	7/32"	0.2187	6"	0.406	0.187
PCL1514	7/32"	0.2187	14"	0.406	0.187
PCL1520	7/32"	0.2187	20"	0.406	0.187
PCL1703	1/4"	0.25	3"	0.437	0.187
PCL1706	1/4"	0.25	6"	0.437	0.187
PCL1714	1/4"	0.25	14"	0.437	0.187
PCL1720	1/4"	0.25	20"	0.437	0.187
PCL1903	9/32"	0.2812	3"	0.437	0.25
PCL1906	9/32"	0.2812	6"	0.437	0.25
PCL1914	9/32"	0.2812	14"	0.437	0.25
PCL2103	5/16"	0.3125	3"	0.5	0.25
PCL2106	5/16"	0.3125	6"	0.5	0.25
PCL2114	5/16"	0.3125	14"	0.5	0.25
PCL2120	5/16"	0.3125	20"	0.5	0.25
PCL2303	11/32"	0.3437	3"	0.562	0.25
PCL2306	11/32"	0.3437	6"	0.562	0.25
PCL2314	11/32"	0.3437	14"	0.562	0.25
PCL2503	3/8"	0.375	3"	0.625	0.25
PCL2506	3/8"	0.375	6"	0.625	0.25
PCL2514	3/8"	0.375	14"	0.625	0.25
PCL2520	3/8"	0.375	20"	0.625	0.25
PCL2703	13/32"	0.4062	3"	0.687	0.25
PCL2706	13/32"	0.4062	6"	0.687	0.25
PCL2714	13/32"	0.4062	14"	0.687	0.25
PCL2903	7/16"	0.4375	3"	0.687	0.25
PCL2906	7/16"	0.4375	6"	0.687	0.25
PCL2914	7/16"	0.4375	14"	0.687	0.25
PCL3303	1/2"	0.5	3"	0.75	0.25
PCL3306	1/2"	0.5	6"	0.75	0.25
PCL3314	1/2"	0.5	14"	0.75	0.25
PCL3503	9/16"	0.5625	3"	0.812	0.25
PCL3506	9/16"	0.5625	6"	0.812	0.25
PCL3514	9/16"	0.5625	14"	0.812	0.25
PCL3703	5/8"	0.625	3"	0.875	0.25
PCL3706	5/8"	0.625	6"	0.875	0.25
PCL3714	5/8"	0.625	14"	0.875	0.25
PCL4103	3/4"	0.75	3"	1	0.25
PCL4106	3/4"	0.75	6"	1	0.25
PCL4114	3/4"	0.75	14"	1	0.25